

大形メタルクラッド固定抵抗器  
Large Capacity Metal-Clad Fixed Resistor

SMV series



こちらをクリック / Click here

デジタルカタログにてご覧ください  
Please see the digital brochure.

抵抗温度特性 Temperature coefficient	20Ω ≤ R ±260ppm/°C max. (常温 Normal temp. ~ 常温 Normal temp.+100°C) 20Ω > R ±400ppm/°C max. (常温 Normal temp. ~ 常温 Normal temp.+100°C)	
定格負荷 Power rating load	ΔR/R ≤ ± (1%+0.05Ω) 最高表面温度 (Max. surface temp. rise) 350°C max.	
短時間過負荷 Short-time overload	アーク焼損等の異常なきこと No evidence of arc damage etc. ΔR/R ≤ ± (2%+0.05Ω)	定格電力×10倍 5秒間負荷 1000% of rated power load for 5 seconds
絶縁抵抗 Insulation resistance	100MΩ min.	DC500V
耐電圧 Dielectric withstanding voltage	機械的損傷及び絶縁破壊なきこと No evidence of mechanical damage or insulation breakdown ΔR/R ≤ ± (0.5%+0.05Ω)	AC2500V for one minute
端子強度 Terminal strength	機械的損傷なきこと No evidence of mechanical damage	引張り (Pull) 45N for 10 ± 1 seconds
耐振性 Vibration	機械的損傷なきこと No evidence of mechanical damage ΔR/R ≤ ± (1%+0.05Ω)	1.5mm 10~55Hz / one minute X, Y and Z each direction for 2 hours

■ 耐候的特性 Environmental characteristics

特性 Characteristics	規格値 Standards	試験方法 Test methods
熱衝撃 Thermal shock	機械的損傷なきこと No evidence of mechanical damage ΔR/R ≤ ± (2%+0.05Ω)	定格負荷30分間 → -40°C 15分間 Power rating load for 30 minutes → -40°C for 15minutes
耐湿性 (定常状態) Humidity (Steady state)	標印、絶縁被覆に著しい損傷なきこと No deterioration of protective coatings or markings ΔR/R ≤ ± (3%+0.05Ω)	DC100V 40°C 95%RH for 500 hours
耐久性 (耐湿負荷) Durability (Moisture resistance)	標印、絶縁被覆に著しい損傷なきこと No deterioration of protective coatings or markings ΔR/R ≤ ± (3%+0.05Ω)	10%負荷 10% of rated power load 90 minutes ON and 30 minutes OFF 40°C 95%RH for 1000 hours
耐久性 (定格負荷) Durability (Nominal load)	標印、絶縁被覆に著しい損傷なきこと No deterioration of protective coatings or markings ΔR/R ≤ ± (5%+0.05Ω)	100%負荷 100% of rated power load 90 minutes ON and 30 minutes OFF 20°C for 1000 hours

■規格 Standards

●形状・寸法 Configuration (mm)

定格電力※ <sup>1</sup>	Power ratings	60W	80W	100W	150W	300W	400W	500W
抵抗値範囲※ <sup>2</sup>	Resistance range	0.5Ω ~ 2.5KΩ	1Ω ~ 2.5KΩ			1Ω ~ 5KΩ		
抵抗値許容差	Resistance tolerance	1Ω ≤ R ±5% (J)			1Ω > R ±10% (K)			
L1		115	140	165	215	215	265	335
L2		75	100	125	175	175	225	295
P		100	125	150	200	200	250	320
W		40 ±1	40 ±1	40 ±1	40 ±1	58 ±1.5	58 ±1.5	58 ±1.5
H		20	20	20	20	30	30	30
J		10 ±3	10 ±3	10 ±3	10 ±3	15 ±5	15 ±5	15 ±5

※<sup>1</sup> 定格電力は放熱板（材質:アルミ 大きさ:150W以下は300X300Xt3 / 300W 400W 500Wは 600X600Xt3(mm)）取付けでの電力です。  
The power rating is measured under the condition that the resistor is installed on the heat sink plate. (The material: aluminium, the size: 300X300Xt3(mm) for under 150W, 600X600Xt3(mm) for 300, 400, 500W)

※<sup>1</sup> 定格電力 750W.1000W品について 別途当社にご相談ください。 Please consult with JRM sales staff for Power rating 750W.1000W type.

※<sup>2</sup> 抵抗値範囲外については 別途当社にご相談ください。 Please consult with JRM sales staff for any resistance outside this range.

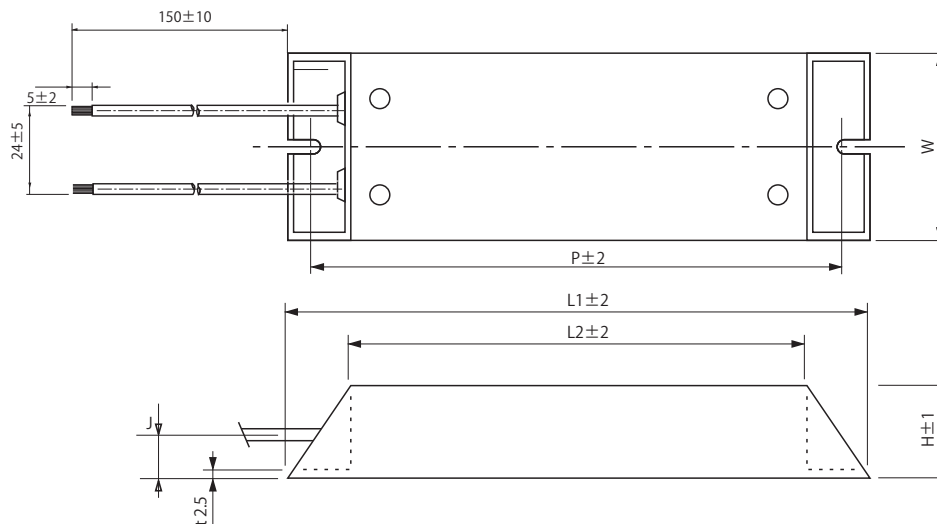

■標準抵抗値

Standard resistance values 1・2・3・5 + JIS-E24 series

■抵抗値許容差 R ≥ 1Ω ----- ± 5% (J)

Resistance tolerance R < 1Ω ----- ± 10% (K)

■受注生産品 Products by order

■基準ロット Standard lot 200個 200pcs

下記標準品抵抗値は小ロット対応致します。  
Standard resistance value indicated below can be provided in smaller lot.

■標準品抵抗値（抵抗値コード表記）

60W	R50K	1R0J	1R5J					
80W	1R0J	1R5J	2R0J					
100W	1R0J	1R5J	2R0J	3R0J	5R0J	100J	150J	
150W	1R5J	2R0J	3R0J	5R0J	100J	150J	200J	
300W	1R5J	2R0J	3R0J	5R0J	100J	150J	200J	300J
400W	2R0J	3R0J	5R0J	100J	150J	200J	300J	
500W	3R0J	5R0J	100J	150J	200J	300J	500J	

■品番コード Explanation of Part Number

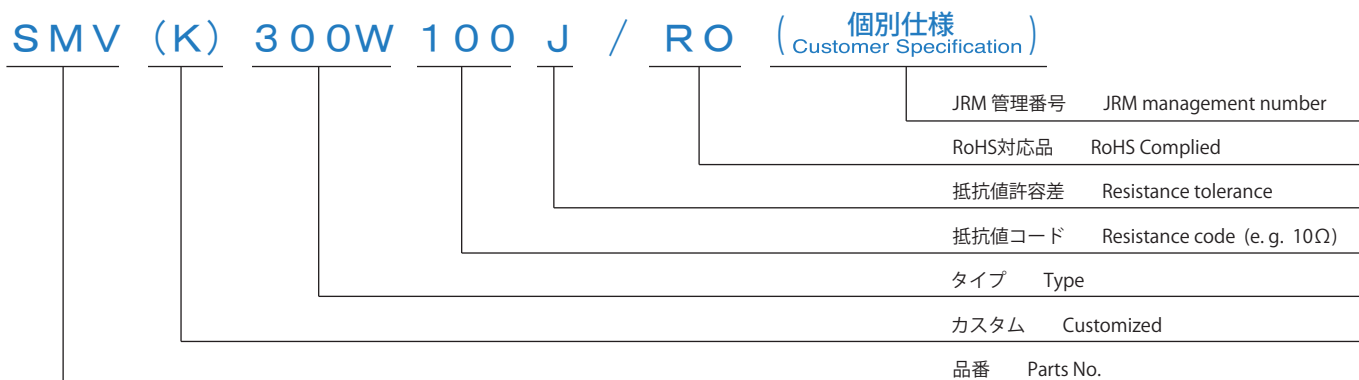

■当カタログは参考仕様ですので、ご使用にあたっては正式納入仕様書の取り交わしをお願いします。  
Specifications in the Catalog are presented basically for in formative purposes,  
We request the exchange of official approval specifications before placing order.